



Tel: +4 0722 279 481
+4 0725 984 004

Email: comercialgritsablare@gmail.com
Web: www.gritsablare.ro

Sustainable Solutions for Blasting & Cleaning
Dedicated Line for Professional Blasting Equipment



Blast Wheel BVM 366 by GritSablare

TECHNICAL DETAILS

Section 1. PRODUCT IDENTIFICATION

Product name

Blast Wheel BVM 366 by GritSablare

Distributor:

GritSablare

Headquarter: 10 Eliza Zamfirescu Leonida Street, Bucharest

Storage & Logistic: Constanța Seaport, Gate 2, SORENA Platform, Constanța, Romania

Phone: (+4) 0722.279.481

Email: comercialgritsablare@gmail.com

Website: www.gritsablare.ro



Section 2. TURBINE'S DESCRIPTION

- High efficiency monowheel BV's turbines mod. BVM 366 are suitable for all shotblasting plants to increase the yield of the treatment.
 - Runner head diameter is 360 mm and is obtained by a singular disk where the components are assembled in easy way.
 - The main feature is a large number six (6) big blades fixed to the disk by means of a quick joint.
 - The shot spread speed is calculated in 82 m/min with RPM 3.000 route/minute.
 - Steel made turbine body finished on CNC machines with all internal wear protection plates made of NI-HARD alloy of easy replacement to warranty a longer protection and duration of the components.
 - Central feeding system with bushing to control the blasting spread direction with easy adjustable device.
 - Direct-coupling electric motors with the runner head and settable by electronic inverter to regulate shot speed and shot flow.
-

Section 3. MAIN COMPONENTS

1. Monowheel built in special steel 18NcD5
 2. Nr. 6 big blades with quick joint built in two version: Ni-Hard (CH7) or in alternative Hard Steel K100
 3. Centrifugal force by special cage in two version: Ni-Hard (CH7) or in alternative Hard Steel K100
 4. Distributor settable shot direction in two version: Ni-Hard (CH7) or in alternative Hard Steel K100
 5. Motor power from kW 7,5 up to kW 60.
 6. Speed and shot regulation by electronic inverter (option).
-

Section 4. STANDARD MOTOR POWER AND SHOT FLOW CAPACITY

- kW 7,5 - kg/min 140
 - kW 11 - kg/min 180
 - kW 15 - kg/min 240
 - kW 18,5 - kg/min 280
 - kW 22 - kg/min 320
-



Tel: +4 0722 279 481
+4 0725 984 004

Email: comercialgritsablare@gmail.com
Web: www.gritsablare.ro

Sustainable Solutions for Blasting & Cleaning
Dedicated Line for Professional Blasting Equipment

Section 5. EXPLODED VIEW

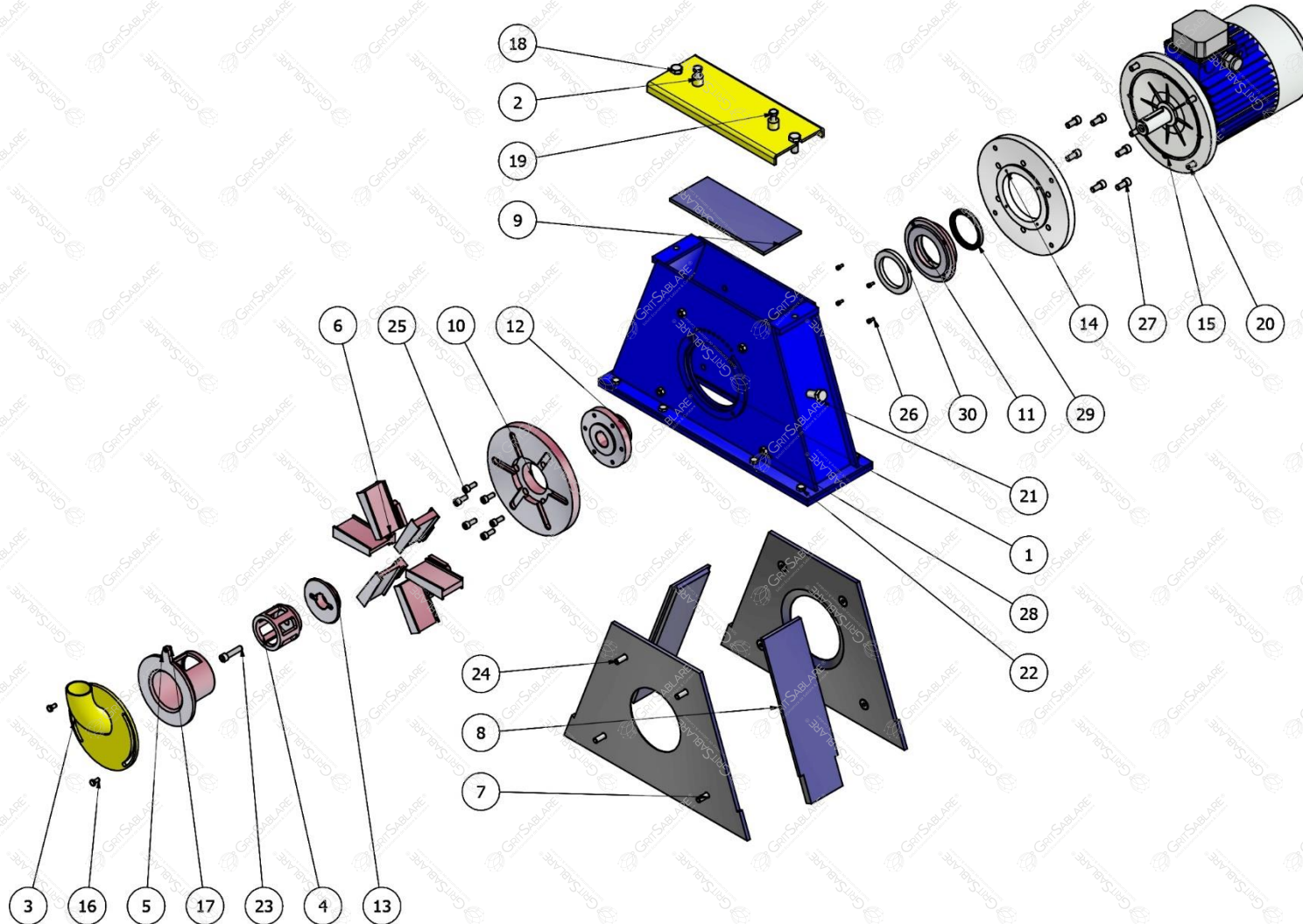



Tel: +4 0722 279 481
+4 0725 984 004

Email: comercialgritsablare@gmail.com
Web: www.gritsablare.ro

Sustainable Solutions for Blasting & Cleaning
Dedicated Line for Professional Blasting Equipment

Section 6. PART LIST

Nr	Product code	Buc	Description	Nr	Product code	Buc	Description	Nr	Product code	Buc	Description	Nr	Product code	Buc	Description	Nr	Product code	Buc	Description
1	20120000-003	1	 Turbine body	7	20120000-009	2	 Trapezoidal cover	13	20120000-016	1	 Spacer	19	ISO 4017 - M12 x 60	2	 Bolt	25	ISO 4762 - M10 x 25	6	 Bolt
2	20120000-004	1	 Cover	8	20120000-010	2	 Side cover	14	20120000-018	1	 Pos-1 Motor Flange	20	ISO 4017 - M12 x 40	4	 Bolt	26	ISO 4762 - M5 x 12	4	 Bolt
3	20120000-005	1	 Feed	9	20120000-011	1	 Upside cover	15	T132SIC411B5 30038X80A002 STD	1	 Motor	21	ISO 4017 - M18 x 60	2	 Bolt	27	ISO 4762 - M12 x 25	6	 Bolt
4	20120000-006	1	 Impeller	10	20120000-012	1	 Disc	16	ISO 4017 - M8 x 16	2	 Bolt	22	ISO 4017 - M12 x 25	8	 Bolt	28	ISO 4032 - M12	8	 Nut
5	20120000-007	1	 Impeller house	11	20120000-013	1	 House sealing	17	ISO 4026 - M8 x 16	1	 Bolt	23	ISO 4762 - M12 x 50	1	 Bolt	29	ISO 6194/1 - 80x100x10-Tip o 2	1	 Sealing ring
6	20120000-008	6	 Vane	12	20120000-014	1	 Shaft	18	ISO 4017 - M16 x 35	2	 Bolt	24	ISO 10642 - M12 x 40	8	 Bolt	30	Sealing 80x110x10	1	 Sealing ring