



## Blasting Cabinet GS2000HD (Heavy Duty) by GritSablare

### TECHNICAL DETAILS

#### Section 1. Product Identification

Product name

Blasting Cabinet GS2000HD (Heavy Duty) by GritSablare

Distributor:

**GritSablare**

Headquarter: 10 Eliza Zamfirescu Leonida Street, Bucharest

Storage & Logistic: Constanța Seaport, Gate 2, SORENA Platform, Constanța, Romania

Phone: (+4) 0722.279.481

Email: comercialgritsablare@gmail.com

Website: www.gritsablare.ro



## Section 2. Product Features:

---

- The Blasting Cabinet GS2000HD by GritSablare highly efficient, extra large capacity industrial blast cabinet, compatible with a wide range of abrasive media, including:
  - Angular Steel Grit Premium & Steel Shots for Shot Peening Premium
  - Stainless Steel Grit & Stainless Steel Cut Wire Shots
  - Red Garnet
  - White Fused Aluminium Oxide Abrasive (WFA) & Brown Fused Aluminium Oxide Abrasive (BFA)
  - Glass Beads
  - Nickel Slag - Angular Blasting Grit
  - Copper Slag
- Cyclone type abrasive separator cleans the abrasive during use.
- Safety door interlock.
- Integral dry cartridge reverse pulse dust collector for clear visibility.
- Heavy duty, wear resistant rubber gloves.
- Quick-change laminated glass viewing window - no tools required.
- Fully adjustable abrasive feed tee.
- Compressed air regulator and gauge.
- High performance Delta Suction Gun.
- Standard air blow down gun.

## Section 3. Common Applications

---

- De-scale and de-rust metal surfaces.
- Remove paint and powder coating.
- De-burr, de-flash and remove sand from castings and mouldings.
- Provide decorative finishes to stainless steel, aluminium and other non-ferrous metals.
- Etching of glass, stone and metals.
- Removal of release agents and contamination from moulds.

## Section 4. Component Highlights

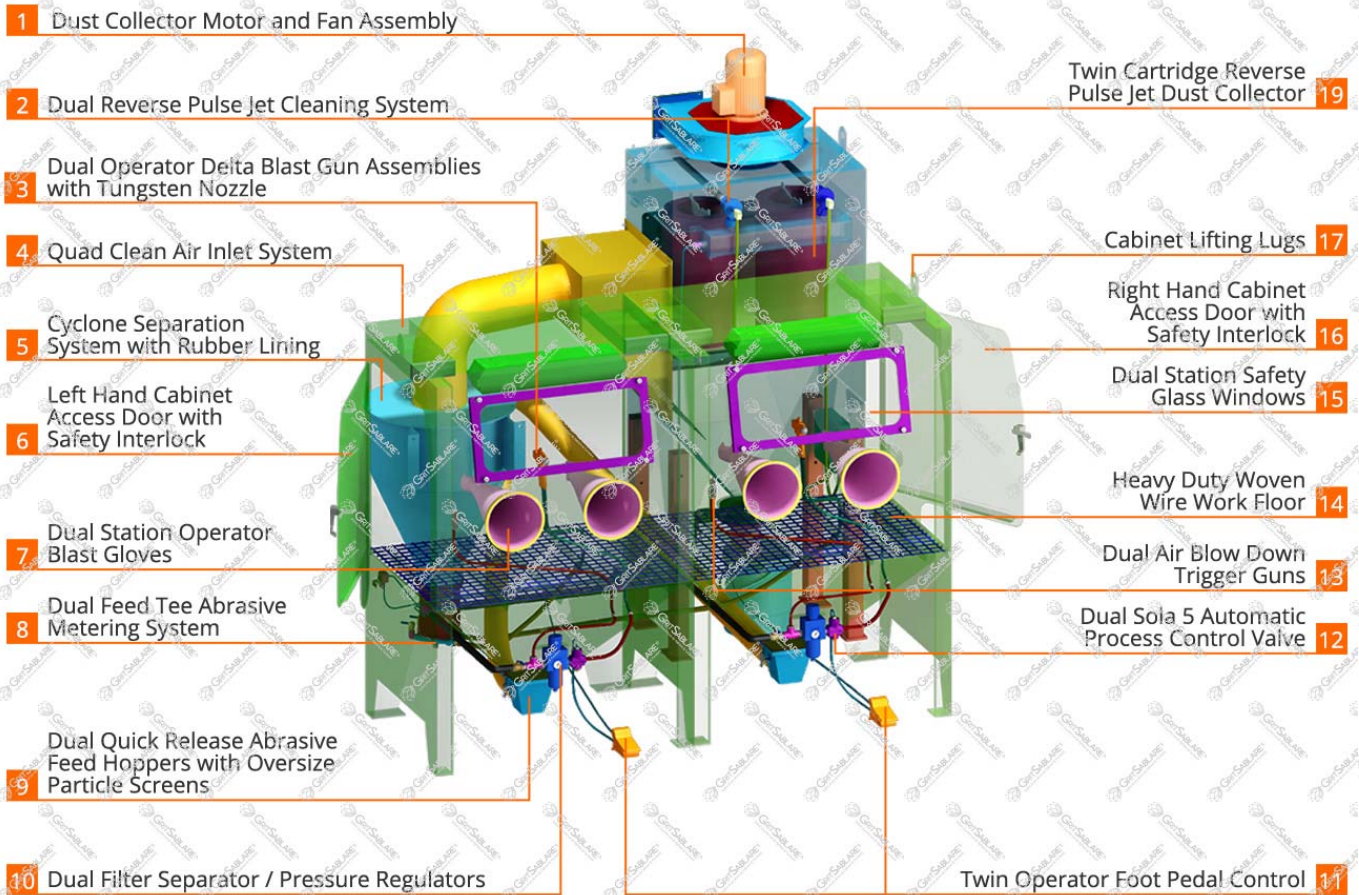

1. Dust Collector Motor & Fan Assembly
2. Dual Reverse Pulse Jet Cleaning System
3. Dual Operator Delta Blast Gun Assemblies with Tungsten Nozzle
4. Quad Clean Air Inlet System
5. Cyclone Separation System with Rubber Lining
6. Left Hand Cabinet Access Door with Safety Interlock
7. Dual Station Operator Blast Gloves
8. Dual Feed Tee Abrasive Metering System
9. Dual Quick Release Abrasive Feed Hoppers with Oversize Particle Screens
10. Dual Filter Separator / Pressure Regulators

11. Twin Operator Foot Pedal Control
12. Dual Sola 5 Automatic Process Control Valve
13. Dual Air Blow Down Trigger Guns
14. Heavy Duty Woven Wire Work Floor
15. Dual Station Safety Glass Windows
16. Right Hand Cabinet Access Door with Safety Interlock
17. Cabinet Lifting Lugs
18. Dual Station Cabinet Lighting
19. Twin Cartridge Reverse Pulse Jet Dust Collector



## Section 5. Technical Data

Optional Turntable Load:	250 kg (551 lbs)
Internal Size:	2000 mm (79") Wide 920 mm (36") Deep 890 mm (35") High
Door Size:	755 mm (30") Wide 855 mm (34") High
Air Consumption:	170 m <sup>3</sup> /hr (100 cfm) @550 kPa (80 psi)
Suction Gun / Nozzle Size:	Delta Manual Gun 3/16" x 3/8" x 2 pcs
Cabinet Light:	4 x 18Watt 230V 50Hz
Cabinet Overall Dimension:	2496 mm (99") Wide 1809 mm (72") Deep 2681 mm (106") High
Recommended Floor Area:	5600 mm (221") Wide 3000 mm (118") Deep
Window Size:	2 x 750 mm (30") Wide 300 mm (12") High
Air Supply Line:	19 mm (3/4")
Electrical Power:	4Kw (5 hp) 415VAC 50Hz 2 Pole 3 Phase

## Section 6. Parts List

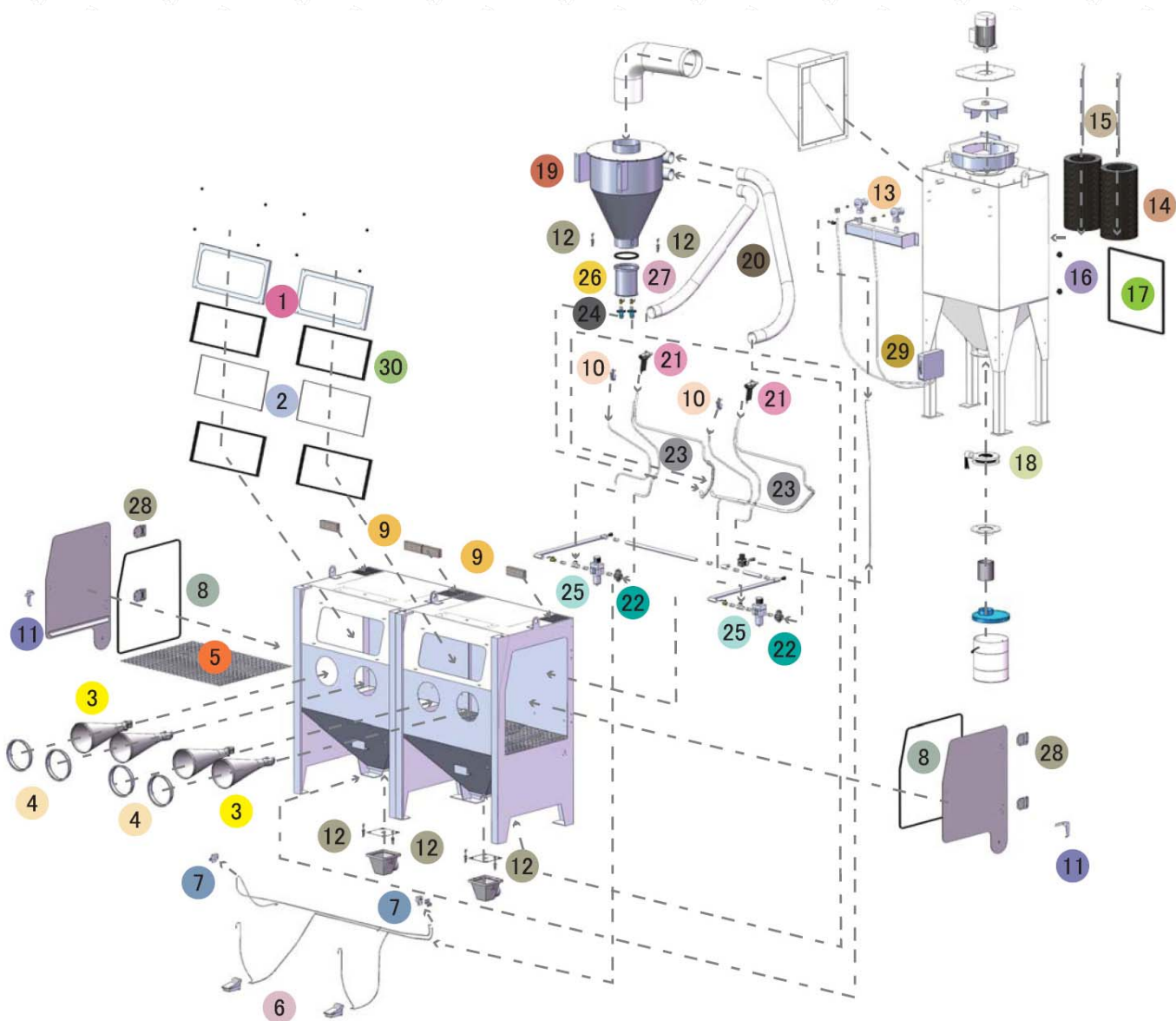



Tel: +4 0722 279 481  
+4 0725 984 004

Email: comercialgritsablare@gmail.com  
Web: www.gritsablare.ro

Sustainable Solutions for Blasting & Cleaning

Dedicated Line for Professional Blasting Equipment

Item	Product Code	Description	Quantity
1	YAC-CA-PB-0101	Window Frame	2
2	BAC-CA-PB-0137	Rectangular Window	2
3	BAC-GL-PB-0003	10" Ø Cabinet Rubber Gloves	2 pr
4	BAC-CA-PB-0157	Cabinet Entry Ring	4
5	BAC-CA-PB-0126	Cabinet Floor Mesh	2
6	BAC-CA-PB-0086	Foot Valve Spring Return	2
7	YAC-CA-PB-0219	Door Interlock Valve	2
8	BAC-CA-PB-0178	Cabinet Door Seal	2
9	BAC-CA-PB-0140	Air Entry Filter	4
10	YAC-CA-PB-0145	1/4" Blow Off Gun	2
11	YAC-CA-PB-0138	Latch	2
12	YAC-FN-PB-0041	Toggle Catch	6
13	YAC-DC-0053-00	Pulse Valve	2
14	BAC-DF-PB-0002	Filter Cartridge - Size 2	2
15	YAC-DC-PB-0005	700 mm Hanger Rod	2
16	YAC-FN-0383-00	Female Star Knob	2
17	BAC-DC-0038-00	Dust Collector Access Door Seal	1
18	BAC-PF-0407-00	Butterfly Valve - 5"	1
19	BAC-CA-PB-0283	GS2000HD Rubber Lined Cyclone	1
20	BAC-CA-0598-00	Recovery Hose	1
21	BAC-BG-PB-0057	Delta-m Gun GDF 3/16 X 3/8 Assembly	2
22	BAC-RC-PB-0142	Sola5 Inlet Valve Sub Assembly	2
23	BAC-CA-0590-00	Abrasives Hose	1
24	BAC-CA-PB-0220	Feed Tee Assembly	2
25	BAC-AF-PB-0047	13 mm (1/2") Filter Regulator With Gauge	2
26	BAC-PF-PB-0001	13 mm (1/2") Ball Valve	2
27	BAC-CA-0353-00	Standard Cyclone Screen Seal	1
28	BAC-CA-PB-0296	Hinge Assembly	4
29	BAC-DC-0061-00	Pulse Timer 2-10 Stations	1
30	BAC-CA-PB-0141	Cabinet Window Seals	4